

ADDITIONS

East Brunswick Township

ADDITION REQUIREMENTS

Provided by Division of Construction Inspection:

1. Construction application.
2. Building, Electrical, Plumbing & Fire Subcode application's.
3. Typical section detail.

Homeowner/Contractor to Provide:

1. Completed construction & subcode applications.
2. Two sets of drawings by homeowner or architect.
3. Electrical and Plumbing Subcodes must be signed and sealed by NJ licensed contractors or the case of the homeowner doing his own work he may sign as an exempt applicant.
4. Two copies of survey showing location of new addition.
5. Zoning sign off.
6. Copy of a contract or a written statement to verify the cost.

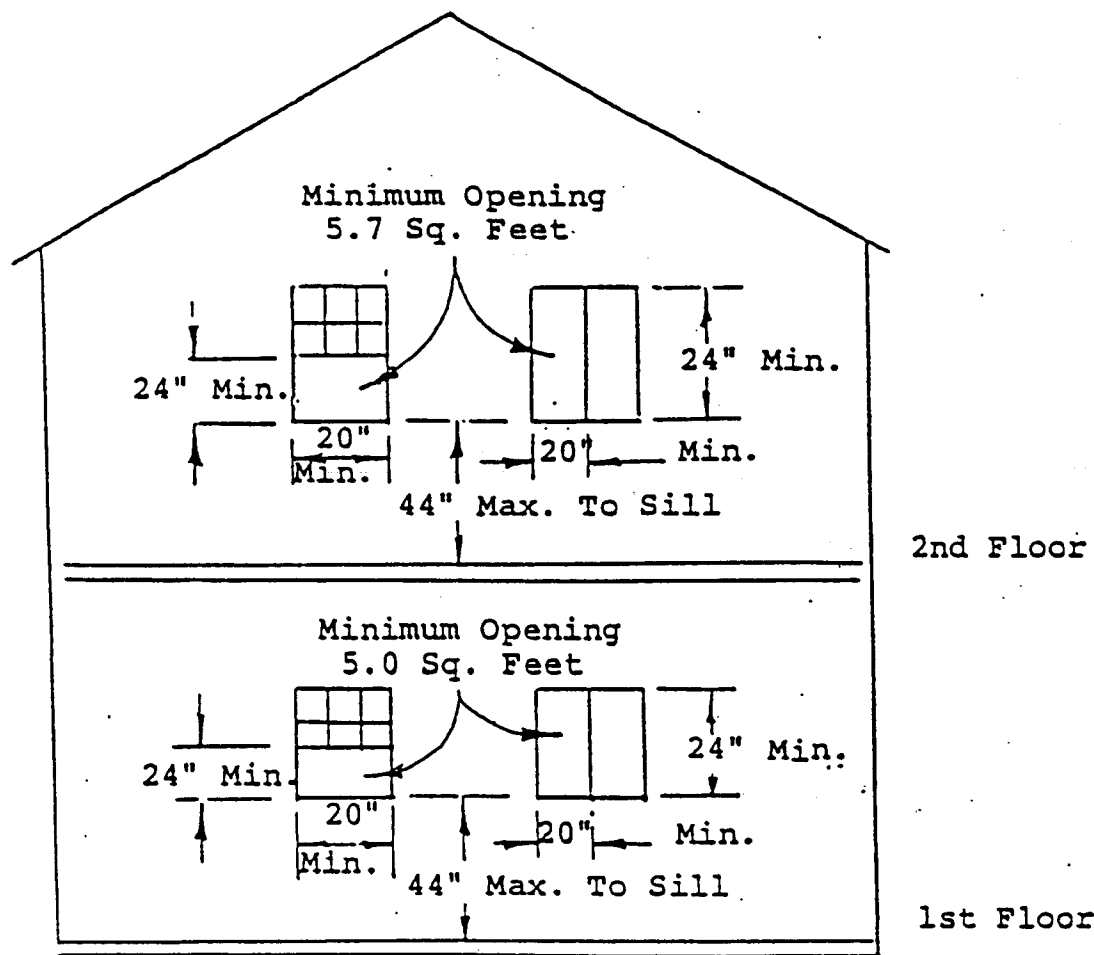

At least ONE window in each sleeping area must meet the minimum requirements as shown above. All sleeping areas require at least one window.

Bedroom replacement windows must be in compliance with current Code requirements.

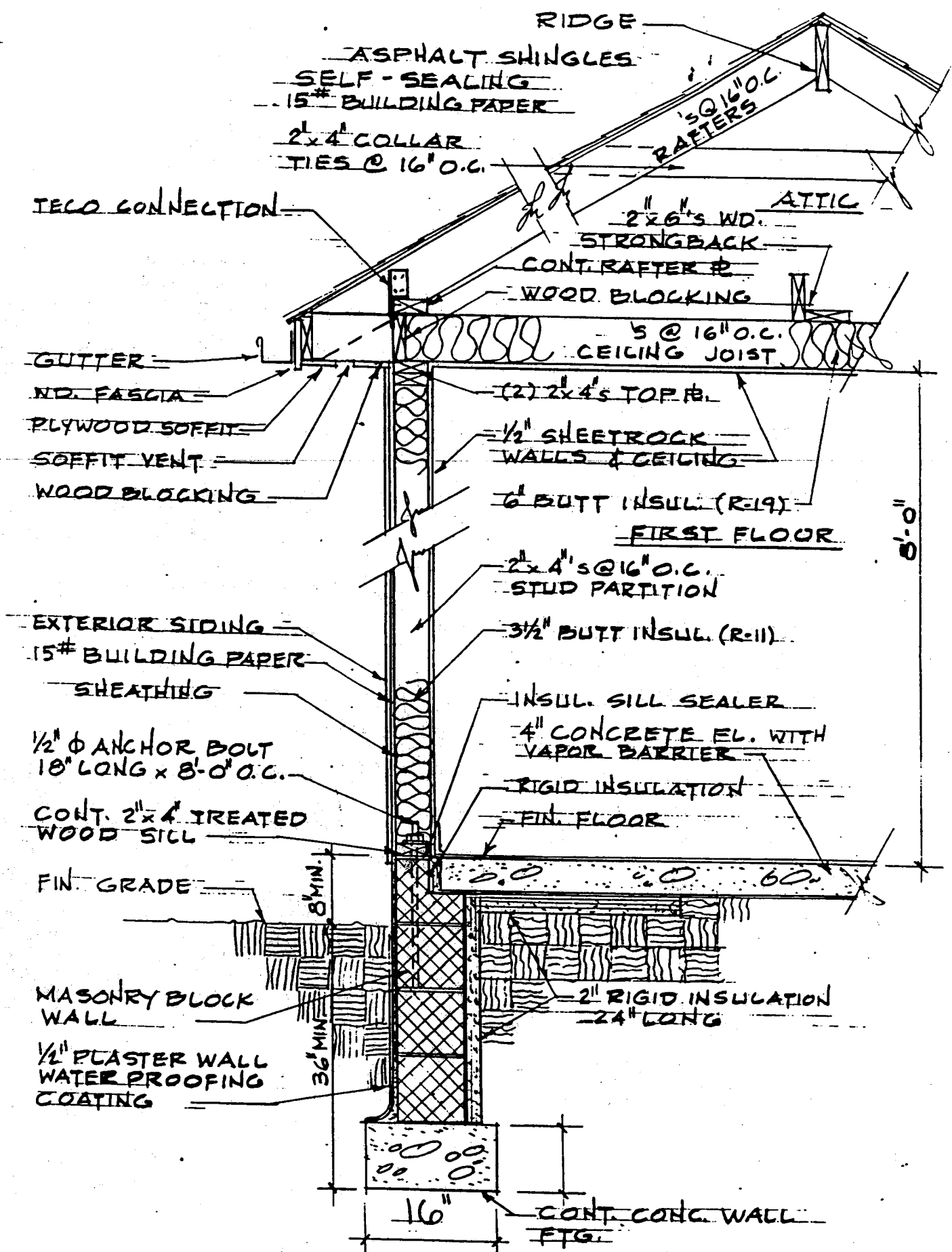

SECTION THRU TYPICAL WALL,
WITH SLAB ON GRADE FOUNDATION
 SCALE: 3/4" = 1'-0"

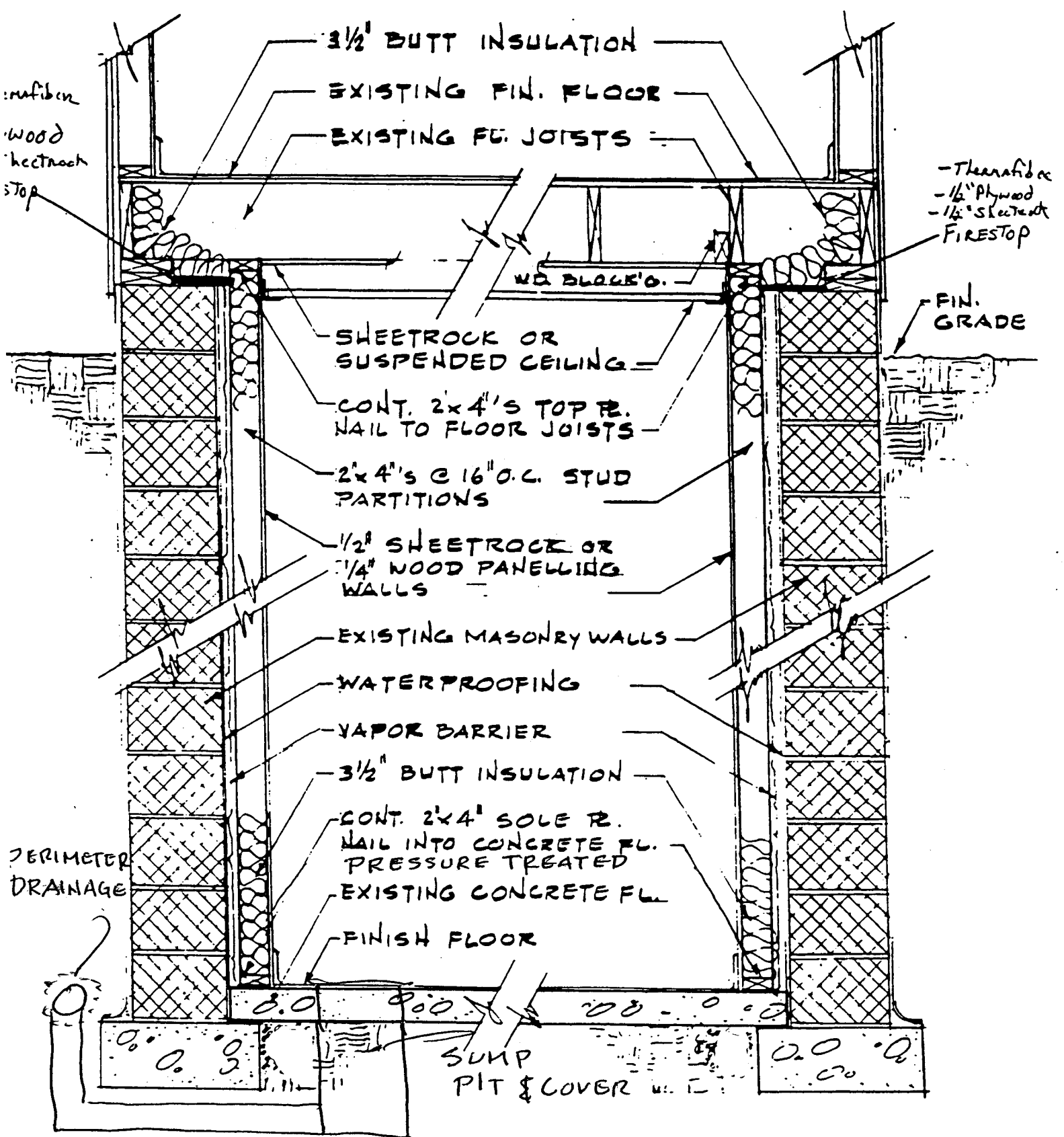

SECTION THRU TYPICAL FINISHED
BASEMENT WALLS

SCALE: 3/4" = 1'-0"

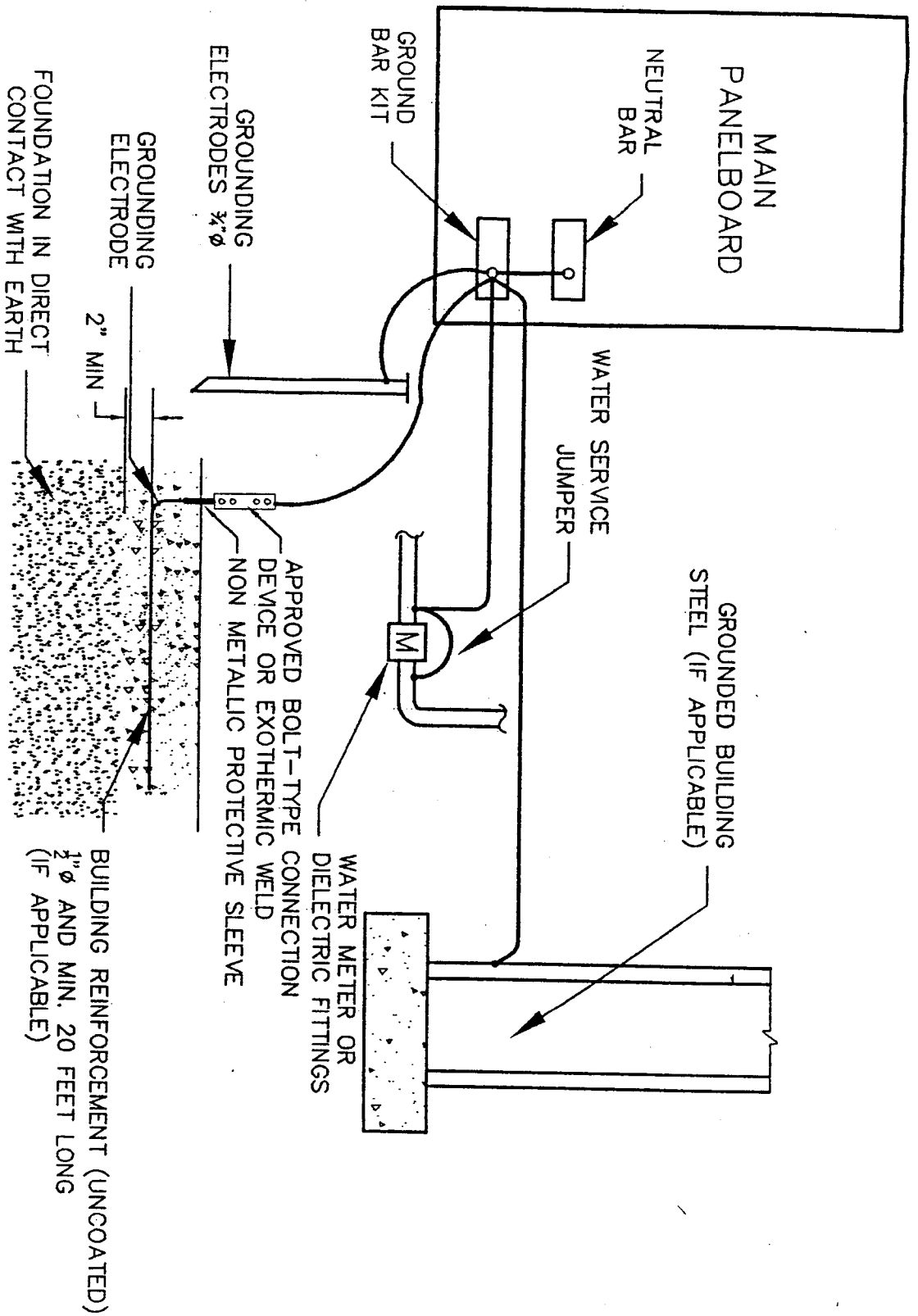

GROUNDING SYSTEM DETAIL

NOT TO SCALE

NOTE: GROUNDING WIRE WILL BE IN ACCORDANCE WITH THE LATEST ADOPTED VERSION OF THE NATIONAL ELECTRICAL CODE, FOR THE SIZE OF THE LARGEST UNGROUNDED SERVICE ENTRANCE CONDUCTOR - ALL FITTINGS SHALL BE LISTED UNDER ARTICLE 250-70